

MICS Main Office (A Building) and Gymnasium (B Building)

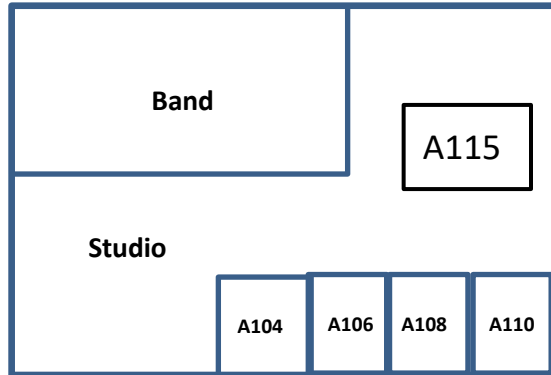

Band Room: M. Ray (Band)/E. Myers (Band)
A115: C. Ward (IT)
A104: J. Hicks (Transportation)
A106: Conference Room
A108: M. Webster (School Nutrition)
A110: A. Wofford (Registrar)

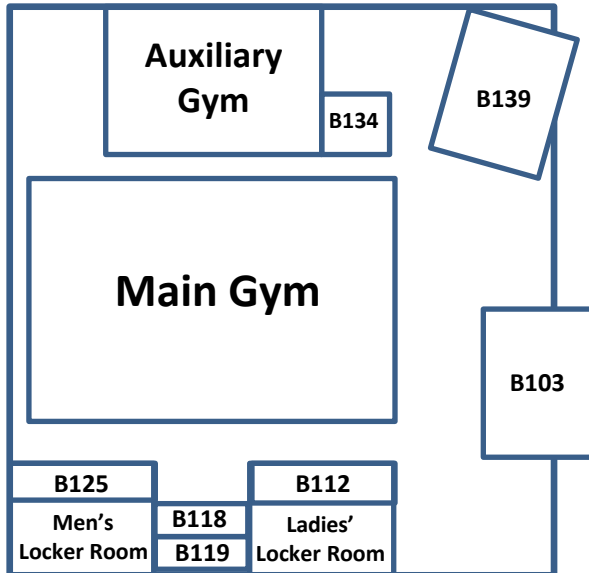

B134: M. Steger (HS Athletic Director)
B139: Athletic Training/Health Room
B125: J. Gibson, Z. Sherman, R. Riley (PE)
B112: D. Pope (PE)
B103: Weight Room
B118/B119: Athletic Trainers

MICS C Building First Floor

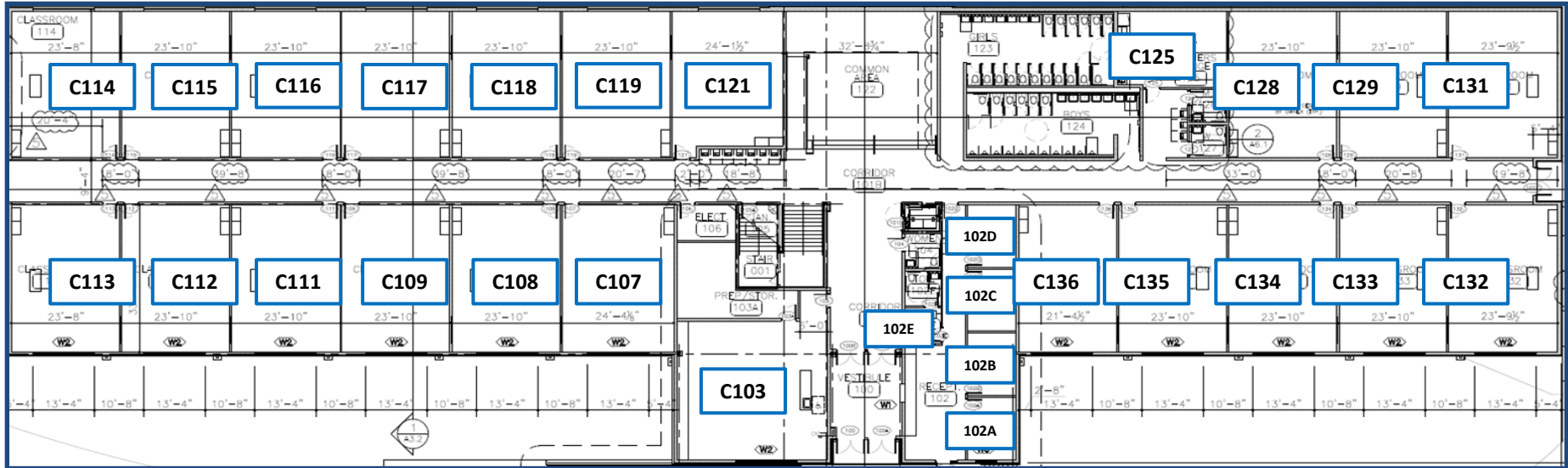

C102 M. Cobb (Front Office Manager)
 C. Brown (Administrative Asst.)
C102A: J. Wilson (MS/HS Principal)
C102B: J. Cratch (MS Counselor)
C102C: G. Cathey (HS Counselor)
C102D: A. Matthews (HS Counselor)
C103: D. Ward (Theatre)

C107: A. Scales (7th Science)
C108: B. Thompson (7th Social Studies)
C109: C. Lockler (MS Intervention)
C111: K. Cook (6th Science)
C112: K. Osterndorf (6th Social Studies)
C113: C. Nance (MS/HS Art)
C114: T. Tolson/Student Support
C115: L. Myers (6th ELA)
C116: N. Simonette (6th Math)
C117: S. Thomas (MS Intervention)
C118: M. Dalton (7th ELA)
C119: J. Alston (7th Math)
C121: J. Carela (MS/HS Spanish)

C128: R. Washington (HS Career Counselor/AD)
C129: J. Spence (MS EC)
C131 Office Suite:
 - T. Stallings (K-12 AP Curriculum & Assessment)
 - R. Goodwin (6-12 AP Curriculum)
 - T. Toteno (MS Assistant Principal)
 - ISS
C132: M. Smith (8th Science)
C133: M. Clevenger (8th Social Studies)
C134: M. Cook (8th ELA)
C135: C. Stuckey (8th Math)
C136: K. Zawistowski (MS EC)

MICS C Building Second Floor

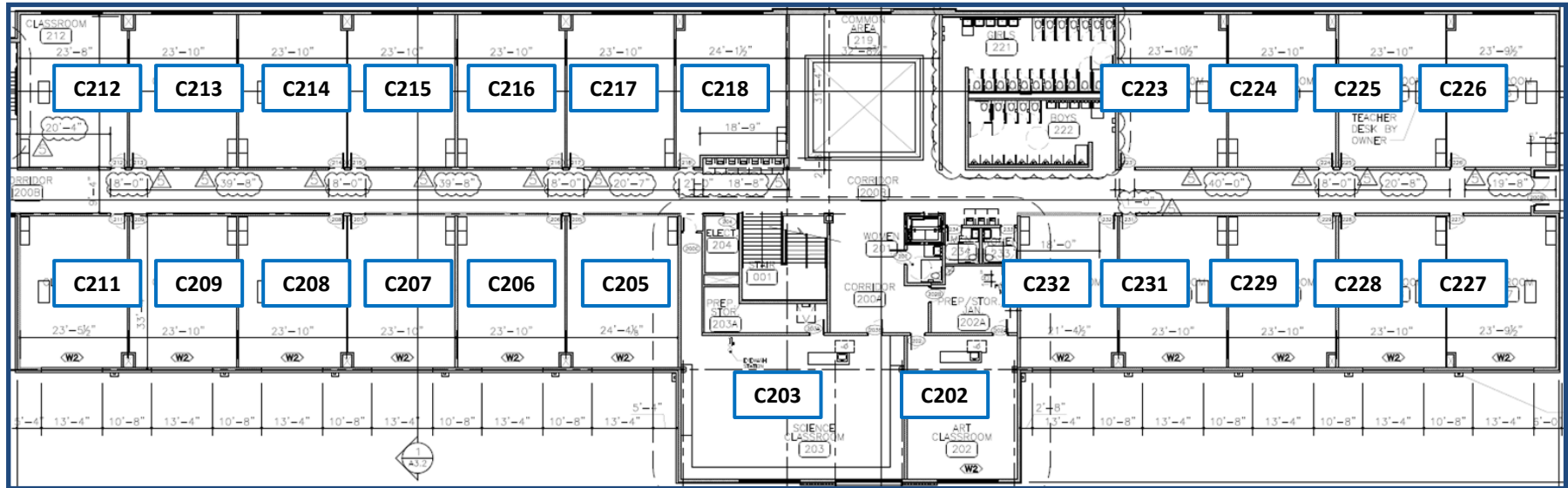

C202: D. Strouse (HS Art)

C203: Science Lab

C205: M. Christopher (HS EC)

J. Kincaid (HS EC)

D. Heim (HS T.A.)

C206: L. Wynn (HS CTE)

C207: L. Whitley (HS Social Studies)

C208: M. Kualii (HS English)

C209: D. Mitchell (HS Social Studies)

C211: S. Koenders (HS English)

C212: N. Wallace (HS Science)

C213: C. Mays (HS Math)

C214: A. Morris-Butler (HS Science)

C215: M. Stowe (HS Math)

C216: V. DeFelice (HS Spanish)

C217: J. Echeverria (HS Spanish)

C218: A. Renzo (HS Science)

C223: B. McIlwain (HS Science)

C224: B. Lawing (HS Math)

C225: R. Koenders (HS Social Studies)

C226: J. Wylie (HS Social Studies)

C227: K. Riddle (HS English)

C228: J. Serra (HS Math)

C229: D. May (HS Math)

C231: M. Belus (HS English)

C232: Office Suite

-J. Gardner (School Resource Officer)

-L. Casey (HS Assistant Principal)

-T. Tolson (AP HS Student Support)

MICS D Building Gym & Cafe

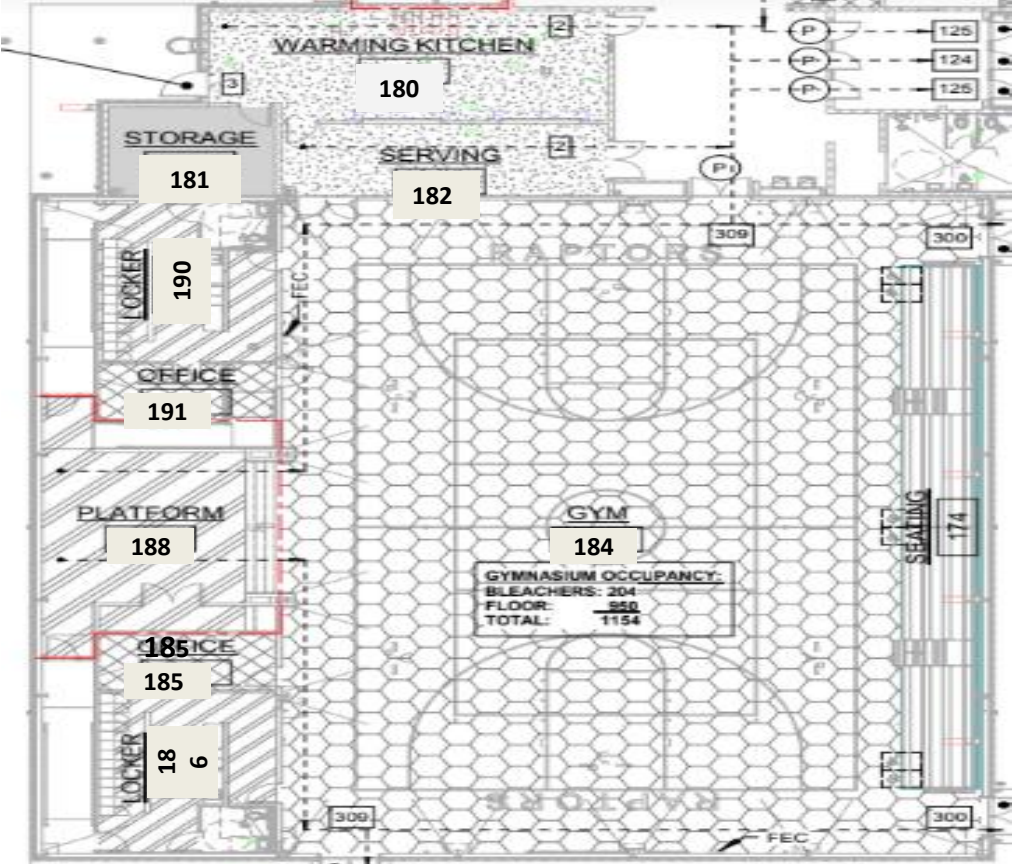

- D180: Kitchen
- D181: Cafe Storage
- D182: Serving Area
- D184: Elementary Gymnasium
- D185: L. Bennett (MS Athletic Director)
- D186: Girls Locker Room
- D188: Stage
- D190: Boys Locker Room
- D191: Watson (PE)

D Building - First Floor

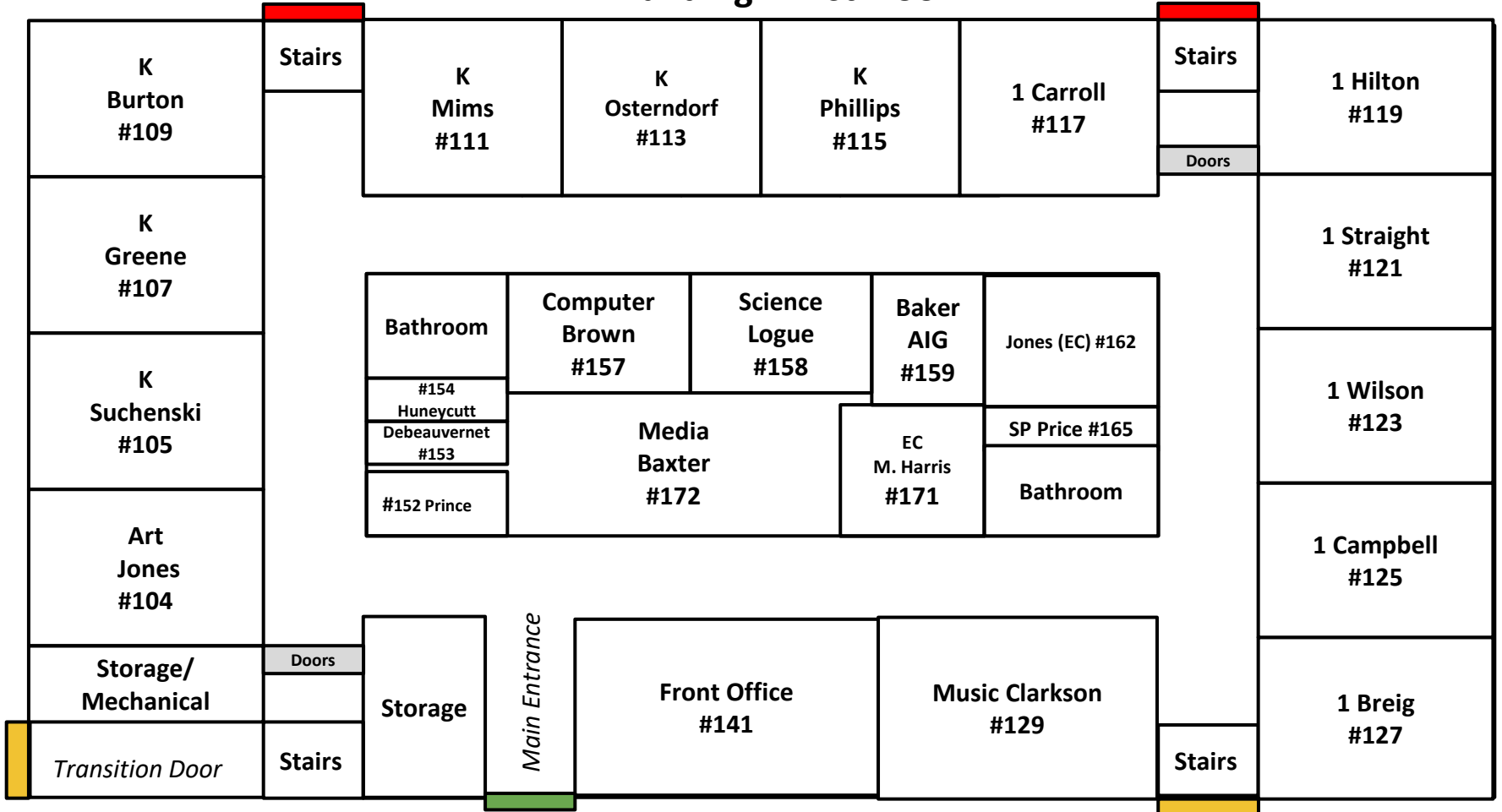

D Building - Second Floor

